

Equipement standard

- airco sur moteur – GPL – radio/CD – TV/DVD/SAT – camera de recul ou radar de recul – garage -
panneau solaire, onduleur 12V / 220V -

Rijbewijs – Permis C

ARTO Lux

L 1250,-

M 1450,-

H 1650,-

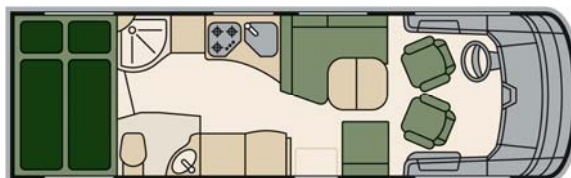

7.77m

4 pers.

5000 kg



FLAIR First Class

L 1550,-

M 1750,-

H 1950,-

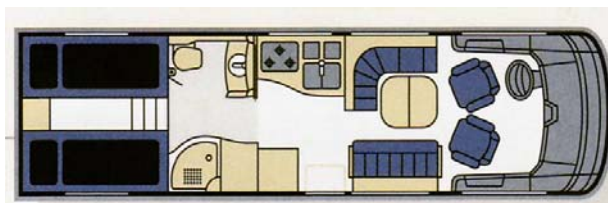

8.60m

4 pers.

6000 kg

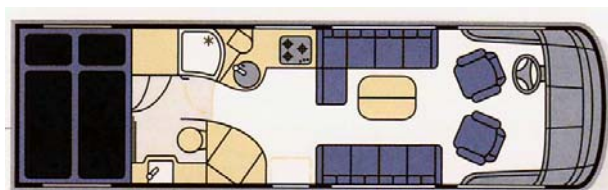

8.50m

4 pers.

6700 kg

Full options
Volledige luchtvering
Automaat

Tout confort
Suspension pneumatique
Boîte automatique